

HardieLine® Cladding - top of siding - ventilation detail

- 1 Ventilation grille
- 2 Ventilation path
- 3 Soffit board
- 4 10mm Ventilation gap
- 5 HardieLine® cladding
- 6 Vertically installed timber framing battens
- 7 Breather membrane
- 8 Masonry
- 9 EPDM

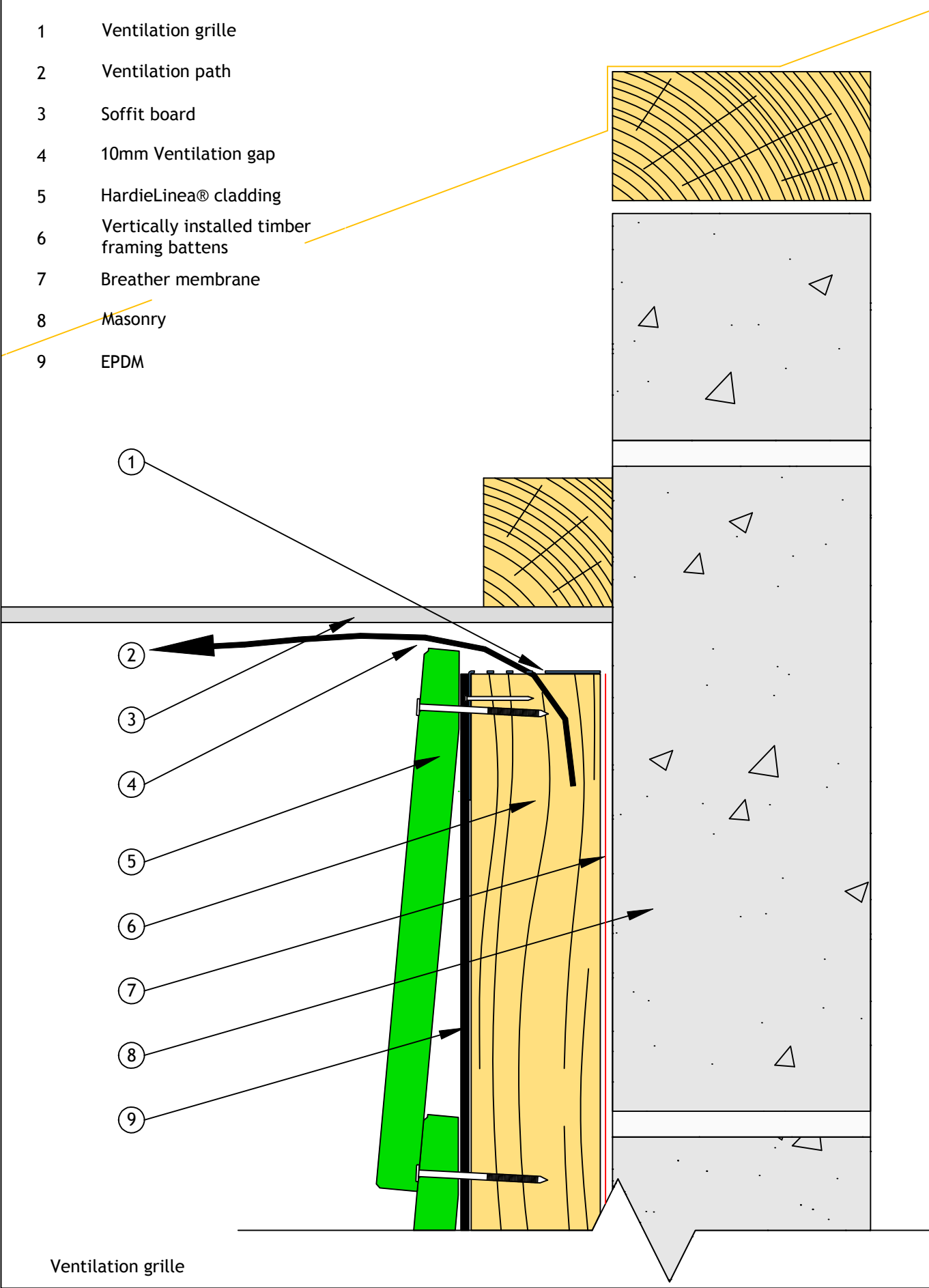

Ventilation grille