

HardiePlank® - Below Rendered Wall

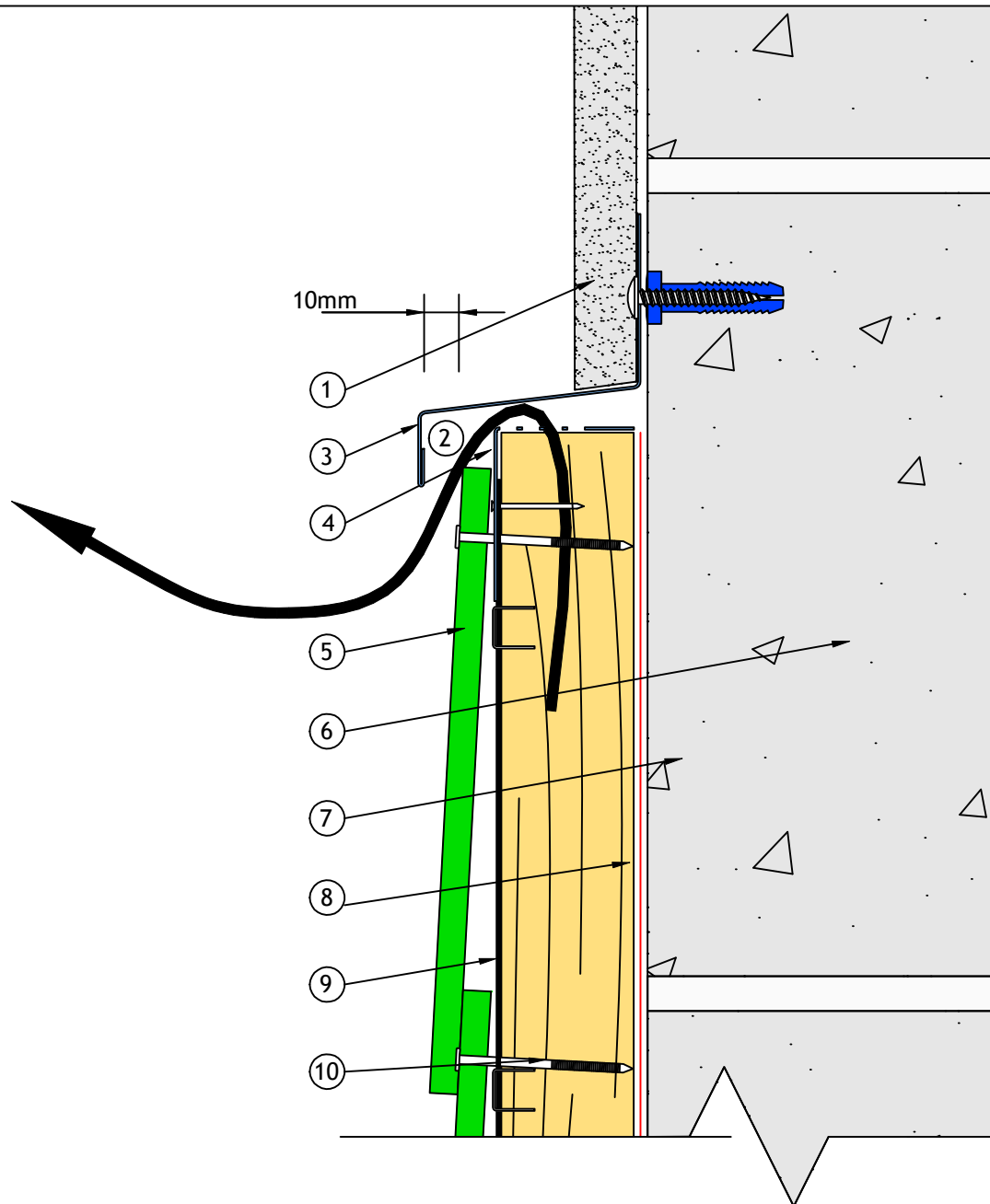

- 1 18mm Render
- 2 Ventilation path
- 3 Metal drip profile screwed to wall
- 4 Hardie Top Vent Profile
- 5 HardiePlank® Cladding
- 6 Masonry
- 7 Breather membrane
- 8 Timber batten 50mm x 50mm
- 9 EPDM
- 10 51x2.95mm fixing