

Installation Details

HardieFloor® Flooring System

This is to be read in conjunction with the HardieFloor® product install guide.

Additional detailing may be required for acoustic floor assemblies.

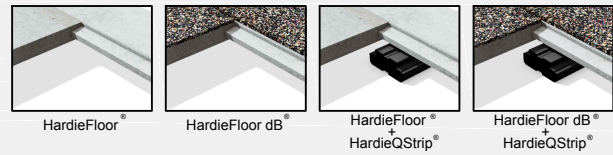

GENERAL INSTALLATION DETAILS

1 FRAME PREPERATION

Floor joists must be reasonably level and must have a maximum spacing of 450mm for 19mm HardieFloor® or 600mm for 22mm HardieFloor®.

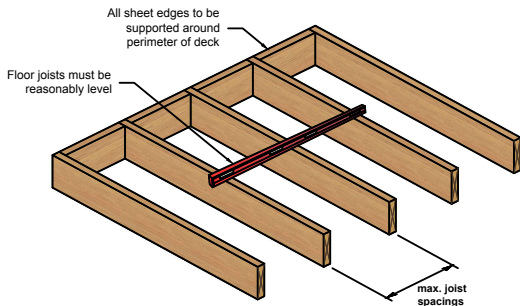

2 FASTENER LAYOUT

Apply a continuous bead of flexible construction adhesive to joists.

Fasteners should not be more than 200mm apart and have a minimum distance 25mm from the tongue and groove edge of HardieFloor® panel, and 12mm from the butt edge. Corner fasteners should be a minimum distance of 50mm from the tongue and groove edge. The third row of fasteners should only be completed after the subsequent adjoining panel has been placed.

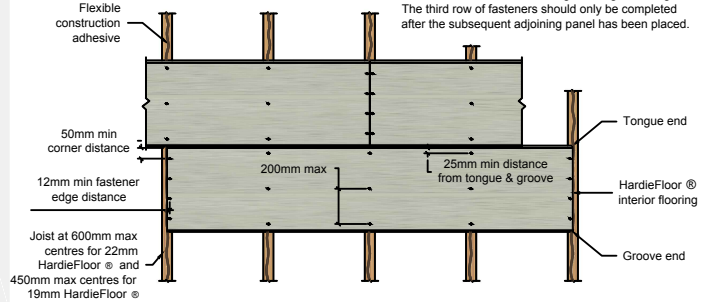

3 SHEET LAYOUT

HardieFloor® panels should be laid in a staggered pattern, like a brick wall. All short, square ends should be fully supported.

Set the next HardieFloor® panel in place. Finish fastening the previous panel by putting in the third row of fasteners then continue fastening.

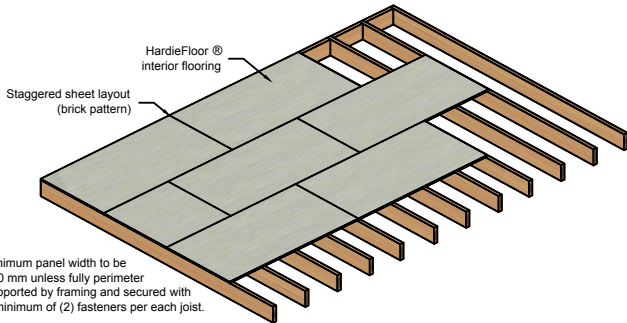

4 BUTT JOINTING - DRY AREAS

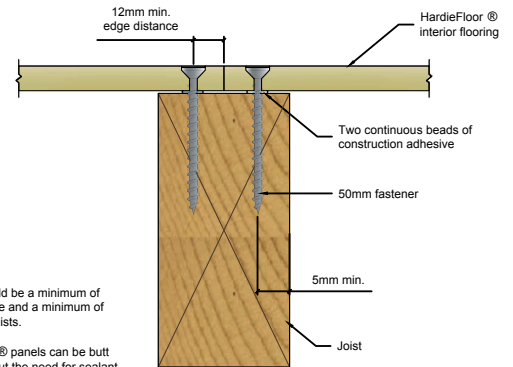

Fixing nails or screws should be a minimum of 12mm from the square edge and a minimum of 5mm from the side of the joists.

For dry areas HardieFloor® panels can be butt jointed flush together without the need for sealant.

5 BUTT JOINT - INTERNAL WET AREAS / ACOUSTIC ASSEMBLIES

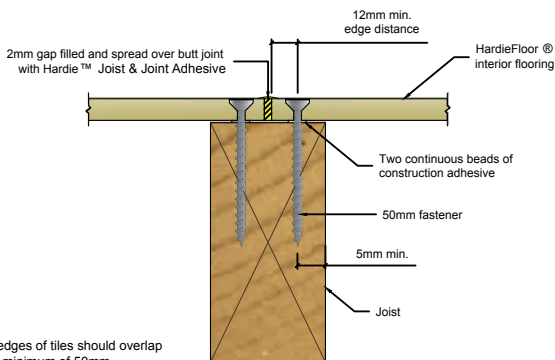

Note: Ideally the edges of tiles should overlap the butt joint by a minimum of 50mm.

6 CONTROL JOINTS

Control joints in the floor sheets are required in dry and wet areas and where existing structural joints are located.

It is important that the control joints be carried through to the top of the floor surface i.e. they should not be covered by tiles or vinyl.

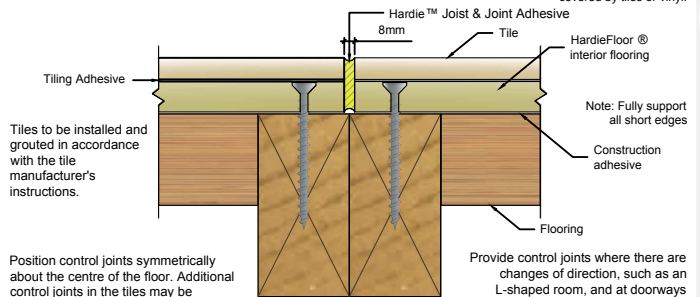

Tiles to be installed and grouted in accordance with the tile manufacturer's instructions.

Position control joints symmetrically about the centre of the floor. Additional control joints in the tiles may be required, refer to the current tile code BS5385 for more information.

Provide control joints where there are changes of direction, such as an L-shaped room, and at doorways where the tiled surface is carried through to the next room.